



# Soft-Glo Mini Dash Display Installation

The IC Soft-Glo Mini Display will mimic the status of the main display during operation. It will not mimic the main display during calibration.

## Step 1: Panel Prep.

Determine location for Mini Display and drill holes as shown - making sure that the smaller hole is at the top left of the pattern.

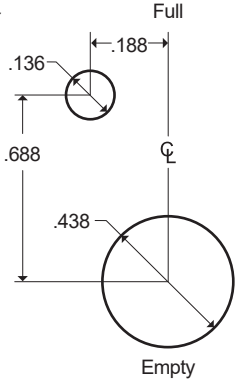

This will ensure that display is installed with the FULL level at the top. The large hole is on the centerline of the display.

## Step 2: Panel Installation

Feed the wire through the large hole in the panel and then through the lock-washer and nut. Make sure that the locating pin on the display is in the smaller hole and then tighten the nut to secure the display.

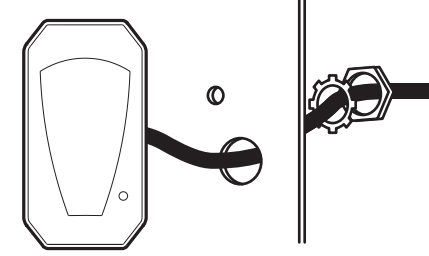

## Step 4: Wiring Plug

Wire the Deutsch 3 socket and 2 socket plugs as follows:

Note: You may find it easier to execute the cable routing in Step 4 before wiring plugs.

**3 Pin Connector**  
A - CAN HI : White  
B - CAN LO: Green  
C - Open (not used)



**2 Pin Connector**  
1 - Red (+)  
2 - Black (GND)



## Step 4: Connect to Main Display

Route cable to Main Display and plug into the Deutsch receptacle harness. Y-connectors and extension cables normally required. See below.

